

Brickcom

2011 BRICKCOM BUYING GUIDE

EN



EXPERT IN WIRELESS IP SURVEILLANCE

BrickOne Solution[®]

(Cameras + Network Equipment + Video Management System)

Network Cameras Wired / Wirelss / 3G, VGA,D1,1M,1.3, 3M, 5M, WDR, Indoor/Outdoor, Vandal Proof, IP67, All the Cameras Accessories

Network Equipment Switch / PoE Switch, WiMAX CPE/BS, MoCA Bridge, HPNA Bridge Power Line Bridge, Wireless AP/Router, 3G Router, Video Server

Video Management System Standalone NVR, PC-NVR, CMS (PC-Base)

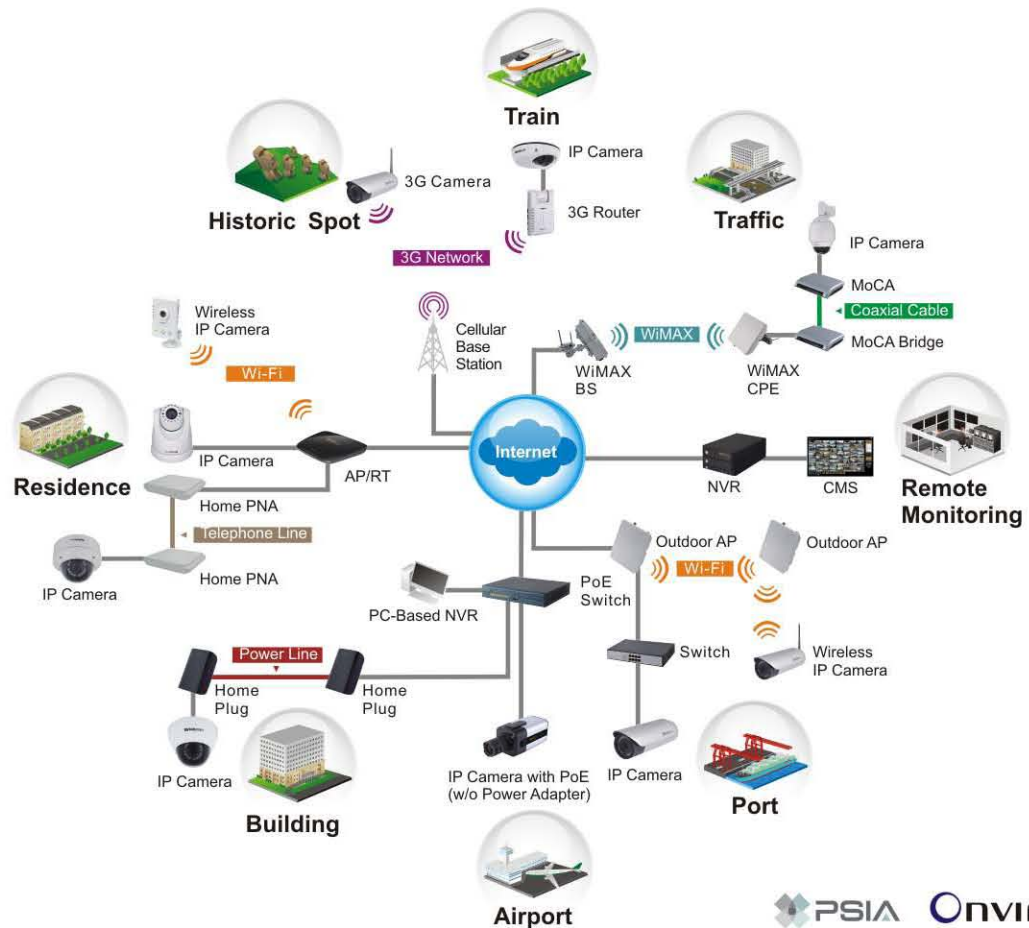

Brickcom

Brickcom Corporation is a leading network video manufacturer in the IP surveillance industry. Dedicated to providing the best IP surveillance solutions, the company is strategically located worldwide to provide prompt quality service. Brickcom has a solid foundation in engineering quality network video equipment with a Research and Development Department that has been producing wireless broadband networking equipment for over twenty years.

We are focused on becoming the world's leading provider of network surveillance solutions. By providing a "One Stop Shop" for all network video security needs, Brickcom technology combines the know-how of broadband wireless networking, optical image processing, and networking surveillance to launch state-of-the-art surveillance solutions with unlimited worldwide applications.

Camera Naming Rule

Camera Type	Sensor Type		
Fixed Box	FB	CMOS	A
Fixed Dome	FD	CCD Progressive	B
Cube	CB	CMOS WDR	C
Bullet	OB	CCD Interlaced (NTSC)	D
Vandal Dome	VD	CCD Interlaced (PAL)	E
Mini Dome	MD	CMOS Sony	N
PTZ	PZ		
Speed Dome	SD		

Resolutions	Specific Features		
D1	04	no	0
1M	10	Cube: PoE	1
1.3M	13	Cube: PoE+CS Mount Lens	2
2M	20		
3M	30		

Wireless Funtion	Version		
no		Economic	e
WiFi	W	Professional	p
3G/3.5G	G	Advanced	a

Example: WFB-100A-31		Example: CB-102A-00	
WiFi	W	Cube	CB
Fixed Box	FB	1M	10
1M	10	PoE and CS Mount	2
No Specific Feature	0	CMOS	A
CMOS	A	Lens Code	00
Lens Code	31		

5M Cube Series







Hardware System	CB-500Ap	WCB-500Ap	CB-502Ap	WCB-502Ap
Flash	32 MB	32 MB	32 MB	32 MB
Memory	256 MB	256 MB	256 MB	256MB
Image sensor	CMOS	CMOS	CMOS	CMOS
Sensor Size/Res	1/2.5" 5M	1/2.5" 5M	1/2.5" 5M	1/2.5"/5M
Shuttler Speed	1/20000~1/2 s	1/20000~1/2 s	1/20000~1/2 s	1/20000~1/2 s
Max. Resolution	2592 x 1944 pixel	2592 x 1944 pixel	2592 x 1944 pixel	2592 x 1944 pixel
Lens Included	Yes	Yes	Yes (Optional)	Yes (Optional)
Lens Mount	Board Mount	Board Mount	CS Mount	CS Mount
Focal Length	f=4mm	f=4mm	f=4.2mm	f=4.2mm
F value	F1.5	F1.5	F1.8	F1.8
View Angle Horizontal	76.7°	76.7°	50°	50°
View Angle Vertical	58.8°	58.8°	37°	37°
View Angle Diagonal	94.7°	94.7°	58°	58°
Min. Illumination	0.5 Lux @ F1.5	0.5 Lux @ F1.5	0.8 Lux @ F1.8	0.8 Lux @ F1.8
Auto Iris Support	NO	NO	NO	NO
Day & Night	Yes	Yes	Yes	Yes
PIR/White LED	V	V	V	V
Multiple Streaming	Yes	Yes	Yes	Yes
Frame Rate (fps)	60 (1M 720p), 30 (2M 1080p), 20 (3M), 15 (4M), 10 (5M)	60 (1M 720p), 30 (2M 1080p), 20 (3M), 15 (4M), 10 (5M)	60 (1M 720p), 30 (2M 1080p), 20 (3M), 15 (4M), 10 (5M)	60 (1M 720p), 30 (2M 1080p), 20 (3M), 15 (4M), 10 (5M)
Audio	Yes	Yes	Yes	Yes
Compression	G.711/AMR	G.711/AMR	G.711/AMR	G.711/AMR
Audio Steaming	2 way	2 way	2 way	2 way
Built-Microphone	V	V	V	V
Built-Speaker	V	V	V	V
Environment	Indoor	Indoor	Indoor	Indoor
Operating Temperature	0°C ~ 50°C (32°F~122°F)	0°C ~ 50°C (32°F~122°F)	0°C ~ 50°C (32°F~122°F)	0°C ~ 50°C (32°F~122°F)
Operating Humidity	10% ~ 80%	10% ~ 80%	10% ~ 80%	10% ~ 80%
General				
DI/DO IO Port	V(1/1)	V(1/1)	V(1/1)	V(1/1)
Wireless (WiFi)	-	802.11 a/b/g/n Dual Band	-	802.12 a/b/g/n Dual Band
Hardware WPS Button	-	V	-	V
Privacy Button	V	V	V	V
USB port for 3G/ 4G	V	-	V	-
Wireless Connection				
Local storage	Micro SD/SDHC Slot Max.32G	Micro SD/SDHC Slot Max.32G	Micro SD/SDHC Slot Max.32G	Micro SD/SDHC Slot Max.32G
Power Input	DC 12V 1A 802.3af POE	DC 12V 1A	DC 12V 1A 802.3af POE	DC 12V 1A -

- Most Intelligent and Compact and Affordable 5M Camera
- HDTV Quality (Full HD 1080p @ 30fps Streaming)
- Unique Design for Low Lux Application (1/2.5" Sensor)
- Intelligent Multi-Profile Sensor Management for Different Environment
- Support 802.11a/b/g/n Dual Band Wireless Connectivity
- WPS Supported for Easy Wireless Network Setup
- Support 3G/ 4G (WiMAX/LTE) Wireless Connectivity
- Interchangeable CS Mount Lens
- Edge Recording/ Micro SD slot
- PoE/ Two-way Audio/ PIR/ Illumination LED/ DIDO/ Privacy button



(PoE) Cube Series

	CB-100Ae / WCB-100Ae (VGA)	CB-100Ae / WCB-100Ae	CB-101Ae	CB-102Ae	CB-100Ap / WCB-100Ap	CB-101Ap	CB-102Ap
Image sensor							
Sensor Size/Res	1/4" CMOS	1/4" 1M CMOS	1/4" 1M CMOS	1/4" 1M CMOS	1/4" 1M CMOS	1/4" 1M CMOS	1/4" 1M CMOS
Shutter Speed	1/24500 s ~ 1/5 s	1/24500 s ~ 1/5 s	1/24500 s ~ 1/5 s	1/24500 s ~ 1/5 s	1/24500 s ~ 1/5 s	1/24500 s ~ 1/5 s	1/24500 s ~ 1/5 s
Max. Resolution	640x400/VGA	1280x800/HDTV	1280x800/HDTV	1280x800/HDTV	1280x800/HDTV	1280x800/HDTV	1280x800/HDTV
Lens	Included	Included	Included	Optional	Included	Included	Optional
Lens Mount	Board Lens	Board Lens	Board Lens	CS Mount	Board Lens	Board Lens	CS Mount
Focal Length	f=3.60mm	f=3.60mm	f=3.60mm	-	f=3.74mm	f=3.74mm	-
F value	F2.3	F2.3	F2.3	-	F2.0	F2.0	-
View Angle Horizontal	55.7°	55.7°	55.7°	-	54.8°	54.8°	-
Auto Iris Support	No	No	No	No	No	No	No
Day & Night							
Mechanical ICR	-	-	-	-	-	-	-
Infrared LED Amount	-	-	-	-	-	-	-
Infrared LED Distance	-	-	-	-	-	-	-
PIR/White LED	-	-	-	-	V	V	V
Video Compression/Frame Rate							
H.264 (fps@max. res.)	V(30 fps)	V(15 fps)	V(15 fps)	V(15 fps)	V(30 fps)	V(30 fps)	V(30 fps)
MPEG-4 (fps@max. res.)	V(30 fps)	V(15 fps)	V(15 fps)	V(15 fps)	V(15 fps)	V(15 fps)	V(15 fps)
Motion JPEG (fps@max. res.)	V(30 fps)	V(30 fps)	V(30 fps)	V(30 fps)	V(30 fps)	V(30 fps)	V(30 fps)
Audio							
Audio Steaming	1 way (Built-in mic)	1 way (Built-in mic)	1 way (Built-in mic)	1 way (Built-in mic)	2 way (Built-in mic & Speaker)	2 way (Built-in mic & Speaker)	2 way (Built-in mic & Speaker)
Environment	Indoor	Indoor	Indoor	Indoor	Indoor	Indoor	Indoor
Vandal-Proof	-	-	-	-	-	-	-
Operating Temperature	0°C ~ 50°C (32°F ~122°F)	0°C ~ 50°C (32°F ~122°F)	0°C ~ 50°C (32°F ~122°F)	0°C ~ 50°C (32°F ~122°F)	0°C ~ 50°C (32°F ~122°F)	0°C ~ 50°C (32°F ~122°F)	0°C ~ 50°C (32°F ~122°F)
Built-in Fan & Heater	-	-	-	-	-	-	-
General							
Analog Video Out	-	-	-	-	-	-	-
Terminal Block	-	-	DI/DO	DI/DO	-	V(1/1)	V(1/1)
Wireless	802.11 b/g/n Single Band *	802.11 b/g/n Single Band *	-	-	802.11 a/b/g/n Dual Band *	UMTS/HSUPA 850/1900/2100 *	UMTS/HSUPA 850/1900/2100 *
Hardware WPS Button	V *	V *	-	-	V *	-	-
Local storage	-	-	-	-	Micro SD/SDHC Slot Max.32G	Micro SD/SDHC Slot Max.32G	Micro SD/SDHC Slot Max.32G
Power Input	DC 12V 1A	DC 12V 1A	DC 12V 1A 802.3af PoE	DC 12V 1A 802.3af PoE	DC 12V 1A	DC 12V 1A 802.3af PoE	DC 12V 1A 802.3af PoE
MAX. Power Consumption	3.1 Watts (3.5 Watts *)	3.1 Watts (3.5 Watts *)	3.8 Watts	3.8 Watts	4.1 Watts (4.5 watts *)	4.8 Watts	4.8 Watts
Others	Max. mic range: 12m (* for WCB-100Ae)	Max. mic range: 12m (* for WCB-100Ae)	Max. mic range: 12m	Max. mic range: 12m	Max. PIR range: 4m Max. mic range: 12m (* for WCB-100Ap)	Max. PIR range: 4m Max. mic range: 12m (* Option)	Max. PIR range: 4m Max. mic range: 12m (* Option)

Fixed BoX Series	Fixed Dome Series
------------------	-------------------

FB-100Ae / WFB-100Ae



e

FB-130Ae / WFB-130Ae



e

FB-100Ap / WFB-100Ap



p

FB-300Ap / WFB-300Ap new



p

FD-100Ae



e

FD-130Ae



e

FD-100Ap



p

Image sensor							
Sensor Size/Res	1/4" CMOS	1/3" 1.3M CMOS	1/4" CMOS	1/4" 3M CMOS	1/4" 1M CMOS	1/3" 1M CMOS	1/4" 1M CMOS
Shutter Speed	1/24500 s ~ 1/5 s	1/18000 s ~ 1/4 s	1/24500 s ~ 1/5 s	1/10000 s ~ 1/7 s	1/24500 s ~ 1/5 s	1/18000 s ~ 1/4 s	1/24500 s ~ 1/5 s
Max. Resolution	1280x800/HDTV	1280x1024/HDTV	1280x800/HDTV	2032x1536/Full HD	1280x800/HDTV	1280x1024/HDTV	1280x800/HDTV
Lens	Optional	Optional	Optional	Optional	Included	Included	Included
Lens Mount	CS Mount	CS Mount	CS Mount	CS Mount	Board Lens	Board Lens	Board Lens
Focal Length	-	-	-	-	f=3.3~12mm	f=3.3~12mm	f=3.3~12mm
F value	-	-	-	-	F1.6	F1.6	F1.6
View Angle Horizontal	-	-	-	-	63.6°~17.9°	89.8°~23.9°	63.6°~17.9°
Auto Iris Support	Yes	Yes	Yes	Yes	Yes	Yes	Yes
Day & Night							
Mechanical ICR	√	√	√	√	√	√	√
Infrared LED Amount	-	-	-	-	12 PCS	12 PCS	12 PCS
Infrared LED Distance	-	-	-	-	15m	15m	15m
PIR/White LED	-	-	-	-	-	-	-
Video Compression/Frame Rate							
H.264 (fps@max. res.)	V(15 fps)	V(15 fps)	V(30 fps)	V(8 fps)	-	-	V(30 fps)
MPEG-4 (fps@max. res.)	V(15 fps)	V(20 fps)	V(15 fps)	V(8 fps)	V(15 fps)	V(20 fps)	V(15 fps)
Motion JPEG (fps@max. res.)	V(30 fps)	V(20 fps)	V(30 fps)	V(6 fps)	V(30 fps)	V(20 fps)	V(30 fps)
Audio							
Audio Steaming	2 way (Built-in mic)	2 way (Built-in mic)	2 way (Built-in mic)	2 way (Built-in mic)	2 way	2 way	2 way
Environment							
Vandal-Proof	-	-	-	-	-	-	-
Operating Temperature	0°C ~ 50°C (32°F ~122°F)	0°C ~ 50°C (32°F ~122°F)	0°C ~ 50°C (32°F ~122°F)	0°C ~ 50°C (32°F ~122°F)	0°C ~ 50°C (32°F ~122°F)	0°C ~ 50°C (32°F ~122°F)	0°C ~ 50°C (32°F ~122°F)
Built-in Fan & Heater	-	-	-	-	-	-	-
General							
Analog Video Out	-	-	-	-	-	-	-
Terminal Block	DI/DO, RS485	DI/DO, RS485	DI/DO, RS485	DI/DO, RS485	DI/DO	DI/DO	DI/DO
Wireless	802.11 b/g/n Single Band *	802.11 b/g/n Single Band *	802.11 a/b/g/n Dual Band *	802.11 a/b/g/n Dual Band *	-	-	-
Hardware WPS Button	√ *	√ *	√ *	√ *	-	-	-
Local storage	-	-	SD/SDHC Slot Max.32G	SD/SDHC Slot Max.32G	-	-	-
Power Input	DC 12V 1A 802.3af PoE	DC 12V 1A 802.3af PoE	DC 12V 1A/AC24V 802.3af PoE	DC 12V 1A/AC24V 802.3af PoE	DC 12V 802.3af PoE	DC 12V 802.3af PoE	DC 12V 802.3af PoE
MAX. Power Consumption	10 Watts	10 Watts	10 Watts	10 Watts	6 Watts	6 Watts	6 Watts
Others							

Max. mic range: 10m
(* for WFB-100Ae

Max. mic range: 10m
(* for WFB-130Ae

Max. mic range: 10m
(* for WFB-100Ap

Max. mic range: 10m
(* for WFB-300Ap

3 axis design

3 axis design

3 axis design

Fixed Dome Series

Vandal Dome Series

FD-130Ap



P

FD-300Ap **new**



P

VD-100Ae



e

VD-130Ae



e

VD-100Ap



P

VD-130Ap



P

VD-300Ap **new**



P

Image sensor							
Sensor Size/Res	1/3" 1.3M CMOS	1/4" 3M CMOS	1/4" 1M CMOS	1/3" 1.3M CMOS	1/4" 1M CMOS	1/3" 1.3M CMOS	1/4" 3M CMOS
Shutter Speed	1/18000 s ~ 1/4 s	1/30000 s ~ 1/7 s	1/24500 s ~ 1/5 s	1/18000 s ~ 1/4 s	1/24500 s ~ 1/5 s	1/18000 s ~ 1/4 s	1/10000 s ~ 1/7 s
Max. Resolution	1280x1024/HDTV	2032x1536/Full HD	1280x800/HDTV	1280x1024/HDTV	1280x800/HDTV	1280x1024/HDTV	2032x1536/Full HD
Lens	Included	Included	Included	Included	Included	Included	Included
Lens Mount	Board Lens	Board Lens	Board Lens	Board Lens	Board Lens	Board Lens	Board Lens
Focal Length	f=3.3~12mm	f=3~9mm	f=3.3~12mm	f=3.3~12mm	f=3.3~12mm	f=3.3~12mm	f=3~9mm
F value	F1.6	F1.6	F1.6	F1.6	F1.6	F1.6	F1.6
View Angle Horizontal	89.8°~23.9°	115.2°~37.1°	63.6°~17.9°	89.8°~23.9°	63.6°~17.9°	89.8°~23.9°	115.2°~37.1°
Auto Iris Support	Yes	Yes	Yes	Yes	Yes	Yes	Yes
Day & Night							
Mechanical ICR	V	V	V	V	V	V	V
Infrared LED Amount	12 PCS	12 PCS	12 PCS	12 PCS	12 PCS	12 PCS	12 PCS
Infrared LED Distance	15m	15m	15m	15m	15m	15m	15m
PIR/White LED	-	-	-	-	-	-	-
Video Compression/Frame Rate							
H.264 (fps@max. res.)	V(20 fps)	V(8 fps)	V(15 fps)	V(15 fps)	V(30 fps)	V(20 fps)	V(8 fps)
MPEG-4 (fps@max. res.)	V(20 fps)	V(8 fps)	V(15 fps)	V(20 fps)	V(15 fps)	V(20 fps)	V(8 fps)
Motion JPEG (fps@max. res.)	V(20 fps)	V(6 fps)	V(30 fps)	V(20 fps)	V(30 fps)	V(20 fps)	V(6 fps)
Audio							
Audio Steaming	2 way	2 way	2 way	2 way	2 way	2 way	2 way
Environment	Indoor	Indoor	Outdoor (IP67)	Outdoor (IP67)	Outdoor (IP67)	Outdoor (IP67)	Outdoor (IP67)
Vandal-Proof	-	-	V	V	V	V	V
Operating Temperature	0°C ~ 50°C (32°F ~122°F)	0°C ~ 50°C (32°F ~122°F)	-20°C ~ 50°C (-4°F ~122°F)	-40°C ~ 60°C (-40°F ~140°F)	-40°C ~ 60°C (-40°F ~140°F)	-40°C ~ 60°C (-40°F ~140°F)	-40°C ~ 60°C (-40°F ~140°F)
Built-in Fan & Heater	-	-	-	-	V	V	V
General							
Analog Video Out	-	-	-	-	-	-	-
Terminal Block	DI/DO	DI/DO	DI/DO	DI/DO	DI/DO	DI/DO	DI/DO
Wireless	-	-	-	-	-	-	-
Hardware WPS Button	-	-	-	-	-	-	-
Local storage	-	-	-	-	SD/SDHC Slot Max.32G	SD/SDHC Slot Max.32G	SD/SDHC Slot Max.32G
Power Input	DC 12V 802.3af PoE	DC 12V 802.3af PoE	DC 48V 802.3af PoE	DC 48V 802.3af PoE	DC 48V High Power PoE	DC 48V High Power PoE	DC 48V High Power PoE
MAX. Power Consumption	6 Watts	6 Watts	25 Watts	25 Watts	25 Watts	25 Watts	25 Watts
Others							
	3 axis design	3 axis design	3 axis design IK10	3 axis design IK10	3 axis design IK10	3 axis design IK10	3 axis design IK10

Mini Dome Series

Bullet Series

MD-100Ae



e

MD-100Ap



3G Option p

OB-100Ae



e

WOB-100Ae



e

OB-100Ap



p

WOB-100Ap



p

GOB-100Ap



3G p

Image sensor							
Sensor Size/Res	1/4" 1M CMOS	1/4" 1M CMOS	1/4" 1M CMOS	1/4" 1M CMOS	1/4" 1M CMOS	1/4" 1M CMOS	1/4" 1M CMOS
Shutter Speed	1/24500 s ~ 1/5 s	1/24500 s ~ 1/5 s	1/24500 s ~ 1/5 s	1/24500 s ~ 1/5 s	1/24500 s ~ 1/5 s	1/24500 s ~ 1/5 s	1/24500 s ~ 1/5 s
Max. Resolution	1280x800/HDTV	1280x800/HDTV	1280x800/HDTV	1280x800/HDTV	1280x800/HDTV	1280x800/HDTV	1280x800/HDTV
Lens	Included	Included	Included	Included	Included	Included	Included
Lens Mount	Board Lens	Board Lens	Board Lens	Board Lens	Board Lens	Board Lens	Board Lens
Focal Length	4.0 mm	2.86 mm	f=3.3~12mm	f=3.3~12mm	f=3.3~12mm	f=3.3~12mm	f=3.3~12mm
F value	F1.8	F2.0	F1.6	F1.6	F1.4	F1.4	F1.4
View Angle Horizontal	56°	81.2°	63.6°~17.9°	63.6°~17.9°	63.6°~17.9°	63.6°~17.9°	63.6°~17.9°
Auto Iris Support	No	No	Yes	Yes	Yes	Yes	Yes
Day & Night							
Mechanical ICR	-	-	V	V	V	V	V
Infrared LED Amount	-	-	24 PCS	24 PCS	24 PCS	24 PCS	24 PCS
Infrared LED Distance	-	-	15m	15m	15m	15m	15m
PIR/White LED	-	-	-	-	-	-	-
Video Compression/Frame Rate							
H.264 (fps@max. res.)	V(15 fps)	V(30 fps)	V(15 fps)	V(15 fps)	V(30 fps)	V(30 fps)	V(30 fps)
MPEG-4 (fps@max. res.)	V(15 fps)	V(15 fps)	V(15 fps)	V(15 fps)	V(15 fps)	V(15 fps)	V(15 fps)
Motion JPEG (fps@max. res.)	V(30 fps)	V(30 fps)	V(30 fps)	V(30 fps)	V(30 fps)	V(30 fps)	V(30 fps)
Audio							
Audio Steaming	-	1 way (Built-in mic)	2 way	2 way	2 way	2 way	2 way
Environment	Outdoor (IP67)	Outdoor (IP67)	Outdoor (IP67)	Outdoor (IP67)	Outdoor (IP67)	Outdoor (IP67)	Outdoor (IP67)
Vandal-Proof	V	V	-	-	-	-	-
Operating Temperature	-20°C ~ 50°C (-4°F ~122°F)	-20°C ~ 50°C (-4°F ~122°F)	-20°C ~ 50°C (-4°F ~122°F)	-20°C ~ 50°C (-4°F ~122°F)	-40°C ~ 60°C (-40°F ~140°F)	-40°C ~ 60°C (-40°F ~140°F)	-40°C ~ 60°C (-40°F ~140°F)
Built-in Fan & Heater	-	-	-	-	V	V	V
General							
Analog Video Out	-	-	-	-	-	-	-
Terminal Block	-	-	DI/DO, RS-485	DI/DO, RS-485	DI/DO, RS-485	DI/DO, RS-485	DI/DO, RS-485
Wireless	-	UMTS/HSUPA 850/1900/2100 *	-	802.11 a/b/g/n Dual Band	-	802.11 a/b/g/n Dual Band	UMTS/HSUPA 850/1900/2100
Hardware WPS Button	-	-	-	-	-	-	-
Local storage	-	Micro SD/SDHC Slot Max.32G	-	-	Micro SD/SDHC Slot Max.32G	Micro SD/SDHC Slot Max.32G	Micro SD/SDHC Slot Max.32G
Power Input	802.3af PoE	PoE 802.3af PoE	DC 12V 1A/AC24V 802.3af PoE	DC 12V 1A/AC24V 802.3af PoE	DC 48V High Power PoE	DC 48V High Power PoE	DC 48V High Power PoE
MAX. Power Consumption	3.5 Watts	3.8 Watts	12 Watts	12 Watts	30 Watts	30 Watts	30 Watts
Others							

EN50155
IK10

Max. mic range: 10m
EN50155, IK10
(*) Option

Smart focus support

Smart focus support

Smart focus support

PTZ	Speed Dome	Video Server Series			
-----	------------	---------------------	--	--	--

PZ-040D/E 12xp



P

OSD-040D/E 36xp



P

VS-01Ae



e

VS-01Ap



P

WVS-01Ap



P

VS-04Ap new



P

Image sensor	Sony Super HAD CCD	Sony Super HAD II CCD& Effio DSP	Image sensor	-	-	-	-
Sensor Size/Res	1/4" D1 CCD	1/4" D1 CCD	Sensor Size/Res	-	-	-	-
Shutter Speed	1/60 ~ 1/100000	NTSC:1/60~1/10000 / PAL:1/50~1/10000	Shutter Speed	-	-	-	-
Max. Resolution	NTSC: 720x480 / PAL: 720x576	NTSC: 720x480 / PAL: 720x576	Max. Resolution	NTSC: 720x480 PAL: 720x576	NTSC: 720x480 PAL: 720x576	NTSC: 720x480 PAL: 720x576	NTSC: 720x480 PAL: 720x576
Lens	Included	Included	Lens	No	No	No	No
Lens Mount	Board Lens	Board Lens	Lens Mount	-	-	-	-
Focal Length	3.8~45.6 mm	3.4~122.4 mm	Focal Length	-	-	-	-
F value	F1.6 - F2.7	F1.6 ~ F4.5	F value	-	-	-	-
Optical Zoom	12x	36x	View Angle Horizontal	-	-	-	-
View Angle Horizontal	4.49°~52.8°	2.0°~61.2°	Auto Iris Support	-	-	-	-
Auto Iris Support	Yes	Yes	Day & Night	-	-	-	-
Day & Night	-	-	Mechanical ICR	-	-	-	-
Mechanical ICR	V	V	Infrared LED Amount	-	-	-	-
Infrared LED Amount	14 PCS	-	Infrared LED Distance	-	-	-	-
Infrared LED Distance	16 m	-	PIR/White LED	-	-	-	-
Video Compression/Frame Rate			Video Compression/Frame Rate				
H.264 (fps@max. res.)	V(NTSC:30 fps / PAL: 25 fps)	V(NTSC:30 fps / PAL: 25 fps)	H.264 (fps@max. res.)	V(NTSC:30 fps / PAL:25 fps)	V(NTSC:30 fps / PAL:25 fps)	V(NTSC:30 fps / PAL:25 fps)	4CH NTSC:15 fps / 4CH PAL:15 fps
MPEG-4(fps@max. res.)	V(NTSC:30 fps / PAL: 25 fps)	V(NTSC:30 fps / PAL: 25 fps)	MPEG-4(fps@max. res.)	V(NTSC:30 fps / PAL:25 fps)	V(NTSC:30 fps / PAL:25 fps)	V(NTSC:30 fps / PAL:25 fps)	4CH NTSC:15 fps / 4CH PAL:15 fps
Motion JPEG(fps@max. res.)	V(NTSC:30 fps / PAL: 25 fps)	V(NTSC:30 fps / PAL: 25 fps)	Motion JPEG(fps@max. res.)	V(NTSC:30 fps / PAL:25 fps)	V(NTSC:30 fps / PAL:25 fps)	V(NTSC:30 fps / PAL:25 fps)	4CH NTSC:15 fps / 4CH PAL:15 fps
Audio			Audio				
Audio Streaming	2 way	2 way	Audio Streaming	2 way (Built-in mic)	2 way (Built-in mic)	2 way (Built-in mic)	2 way (Built-in mic)
Environment	Indoor	Outdoor (IP66)	Environment	Indoor	Indoor	Indoor	Indoor
Vandal-Proof	-	-	Vandal-Proof	-	-	-	-
Operating Temperature	-10°C ~ 50°C (14°F ~122°F)	-45°C ~+50°C (-49°F ~122°F)	Operating Temperature	0°C ~ 50°C (32°F ~122°F)	0°C ~ 50°C (32°F ~122°F)	0°C ~ 50°C (32°F ~122°F)	0°C ~ 40°C (32°F ~104°F)
Built-in Fan & Heater	-	V	General				
Pan/ Tilt			Analog Video Out	V	V	V	V
Pan Range	Endless 360°	Endless 360°	Terminal Block	DI/DO, RS-485	DI/DO, RS-485	DI/DO, RS-485	DI/DO, RS-485
Pan Speed	0.5°~120°/s	0.5°~400°/s	Wireless	-	-	802.11 a/b/g/n Dual Band	-
Tilt Range	90°(0°~90°)	200°(-10°~190°)	Hardware WPS Button	-	-	V	-
Tilt Speed	0.5°~120°/s	0.5°~400°/s	Local storage	-	SD/SDHC Slot Max.32G	SD/SDHC Slot Max.32G	-
General			Power Input	DC 12V 1A 802.3af PoE	DC 12V 1A/AC24V 802.3af PoE	DC 12V 1A/AC24V 802.3af PoE	DC 12V 1A
Analog Video Out	V	V	MAX. Power Consumption	10 Watts	10 Watts	10 Watts	7 Watts
Terminal Block	D/DO	DI/DO	Others				
Local storage	-	-		Max. mic range: 10m	3D de-interlace, 3D noise reduction,	3D de-interlace, 3D noise reduction,	
Power Input	High Power PoE/ DC12V 2A	AC 24V			Max. mic range: 10m	Max. mic range: 10m	
MAX. Power Consumption	17 Watts	65 Watts					
Others							

Regional privacy mask: 8

Regional privacy mask: 16

Superior Night Vision N Series Product



	FB-130Np	WFB-130Np	FD-130Np	VD-130Np	OB-130Np	WOB-130Np	GOB-130Np
Image sensor	Sony Exmor™ CMOS Sensor & ISP	Sony Exmor™ CMOS Sensor & ISP					
Sensor Size/Res	1/3" 1.3M CMOS	1/3" 1.3M CMOS	1/3" 1.3M CMOS	1/3" 1.3M CMOS	1/3" 1.3M CMOS	1/3" 1.3M CMOS	1/3" 1.3M CMOS
Shutter Speed	1/30000 s ~ 1 s	1/30000 s ~ 1 s	1/30000 s ~ 1 s	1/30000 s ~ 1 s	1/30000 s ~ 1 s	1/30000 s ~ 1 s	1/30000 s ~ 1 s
Max. Resolution	1280x1024/HDTV	1280x1024/HDTV	1280x1024/HDTV	1280x1024/HDTV	1280x1024/HDTV	1280x1024/HDTV	1280x1024/HDTV
Lens	Optional	Optional	Included	Included	Included	Included	Included
Lens Mount	CS Mount	CS Mount	Board Lens	Board Lens	Board Lens	Board Lens	Board Lens
Focal Length	-	-	f=3~9mm	f=3~9mm	f=2.8~10mm	f=2.8~10mm	f=2.8~10mm
F value	-	-	F1.6	F1.6	F1.3	F1.3	F1.3
View Angle Horizontal	-	-	115.2°~37.1°	115.2°~37.1°	100.0°~27.3°	100.0°~27.3°	100.0°~27.3°
Auto Iris Support	Yes	Yes	Yes	Yes	Yes	Yes	Yes
Day & Night							
Mechanical ICR	V	V	V	V	V	V	V
Infrared LED Amount	-	-	12 PCS	12 PCS	24 PCS	24 PCS	24 PCS
Infrared LED Distance	-	-	15m	15m	15m	15m	15m
PIR/White LED	-	-	-	-	-	-	-
Video Compression/Frame Rate							
H.264 (fps@max. res.)	V(25 fps)	V(25 fps)	V(25 fps)	V(25 fps)	V(25 fps)	V(25 fps)	V(25 fps)
MPEG-4 (fps@max. res.)	V(15 fps)	V(15 fps)	V(15 fps)	V(15 fps)	V(15 fps)	V(15 fps)	V(15 fps)
Motion JPEG (fps@max. res.)	V(15 fps)	V(15 fps)	V(15 fps)	V(15 fps)	V(15 fps)	V(15 fps)	V(15 fps)
Audio							
Audio Steaming	2 way (Built-in mic)	2 way (Built-in mic)	2 way	2 way	2 way	2 way	2 way
Environment	Indoor	Indoor	Indoor	Outdoor (IP67)	Outdoor (IP67)	Outdoor (IP67)	Outdoor (IP67)
Vandal-Proof	-	-	-	V	-	-	-
Operating Temperature	0°C ~ 50°C (32°F ~122°F)	0°C ~ 50°C (32°F ~122°F)	0°C ~ 50°C (32°F ~122°F)	-40°C ~ 60°C (-40°F ~140°F)	-40°C ~ 60°C (-40°F ~140°F)	-40°C ~ 60°C (-40°F ~140°F)	-40°C ~ 60°C (-40°F ~140°F)
Built-in Fan & Heater	-	-	-	V	V	V	V
General							
Analog Video Out	-	-	-	-	-	-	-
Terminal Block	DI/DO, RS485	DI/DO, RS485	DI/DO	DI/DO	DI/DO, RS-485	DI/DO, RS-485	DI/DO, RS-485
Wireless	-	802.11 a/b/g/n Dual Band	-	-	-	802.11 a/b/g/n Dual Band	UMTS/HSUPA 850/1900/2100
Hardware WPS Button	-	V	-	-	-	-	-
Local storage	SD/SDHC Slot Max.32G	SD/SDHC Slot Max.32G	-	SD/SDHC Slot Max.32G	Micro SD/SDHC Slot Max.32G	Micro SD/SDHC Slot Max.32G	Micro SD/SDHC Slot Max.32G
Power Input	DC 12V 1A/AC24V 802.3af PoE	DC 12V 1A/AC24V 802.3af PoE	DC 12V 802.3af PoE	DC 48V High Power PoE	DC 48V High Power PoE	DC 48V High Power PoE	DC 48V High Power PoE
MAX. Power Consumption	10 Watts	10 Watts	6 Watts	25 Watts	30 Watts	30 Watts	30 Watts
Others	Superior night vision Max. mic range: 10m	Superior night vision Max. mic range: 10m	3 axis design	3 axis design IK10	Smart focus support	Smart focus support	Smart focus support

Video Management System

NR-1604



P

NR-04A



P

BRC64



General	NR-1604	NR-04A	BRC64
Camera Support	1~16	1~4	1~64
Compression Format	Motion-JPEG/ MPEG-4/ H.264	Motion-JPEG/ MPEG-4/ H.264	Motion-JPEG/ MPEG-4/ H.264
E-Map	√	√	√
Video Access by Web Browser	√	√	√
PTZ Control	√	√	√
Preset Control	√	√	-
Recording			
Continuous Recording	√	√	√
Manual Recording	√	√	√
Schedule Recording	√	√	√
Alarm Recording	√	√	√
Audio Recording *	√	√	-
Buffer Storage for Alarm Images (before and after events)	Pre-recording: 0~3 sec Post-recording: 5~30 sec	Pre-recording: 0~3 sec Post-recording: 5~30 sec	Post-recording: 1~600 sec
Recording Performance (FPS) up to	Max. 8Mbps	Max. 8Mbps	depends on PC H/W SPEC
Playback			
Playback Mode	Play/Pause/Stop/Forward/ Reverse/Speed Adjust/ Frame by Frame	Play/Pause/Stop/Forward/ Reverse/Speed Adjust/ Frame by Frame	Play/Pause/Stop/Forward/ Reverse/Speed Adjust/ Frame by Frame
Video Search	Time/Date, Event	Time/Date, Event	Time/Date, Event
Multi-channel Playback	√	√	-
Security			
User Authority Management	Add/Edit/Delete	Add/Edit/Delete	-
Concurrent Login to the Unit	Up to 4 clients (suggested)	Up to 4 clients (suggested)	1 client
Network			
DHCP Client Support	√	√	-
DHCP Server	√	√	-
UPnP Support	√	√	√
I/O Port			
USB 2.0	2xUSB 2.0 (for UPS)	2xUSB 2.0 (for UPS)	depends on PC H/W SPEC
Network Port	High-speed Giga LAN Port * 1	High-speed Giga LAN Port * 1	depends on PC H/W SPEC
HDD i/f	SATA x 2, 2TB per slot	SATA x 2, 2TB per slot	depends on PC H/W SPEC
OS Supported(for client PC)			

Camera Accessories

Lens	Model name	Product Name	Supported Models
	YV2.1x2.8SR4A-SA2	2.1x Vari-focal Lens with DC Iris	Fixed Box Series
	T3Z2914CS-IR	3x Vari-focal Lens with Manual Iris	FB-100A / FB-130A Series
	TG3Z2914FCS-IR	3x Vari-focal Lens with DC Iris	FB-100A / FB-130A Series
	YV10x5HR4A-SA2	10x Vari-focal Lens with DC Iris	FB-100A/ FB-130A/ FB-130N Series
Outdoor Enclosure			
	EN-2070	Infrared Illuminator Enclosure	Fixed Box Series
	EN-1000	Outdoor Enclosure	Fixed Box Series
	EN-1000 (1 unit of IR040)	Outdoor Enclosure with 1 Unit of Infrared Illuminator	Fixed Box Series
	EN-1000 (2 units of IR040)	Outdoor Enclosure with 2 Units of Infrared Illuminators	Fixed Box Series
Camera Bracket			
	CI-803 A CI-803 C	Camera Bracket	Fixed Box / (PoE) Cube Series
	CI-807	Camera Bracket	Bullet Series
	CI-812	Camera Bracket	Bullet Professional Series
	GL-222	Camera Bracket	Cube Series
	D77H03-WSP D77H03-WMP	Pendant Mini Pendant	Speed Dome Series

Camera Accessories

Camera Bracket	Model name	Product Name	Supported Models
	CI-808 CI-815	Pole Mount	CI-807 / CI-812
	D77H03-WST1 D77H03-WST2	25/50cm Straight Tube	Speed Dome Series
	D77H05-WWBM D77H05-WCTB D77H05-WPTB	Wall/Corner/Pole Box Mount	Speed Dome Series
	D77H05-WCST	Corner Plate Mount	Speed Dome Series
	D77H05-WPTD	Pole Direct Mount	Speed Dome Series
	DH801-S DH801-V	Smoke/Vandal-proof Cover	Speed Dome Series
Antenna			
	GEM04-222008A	Wi-Fi Dual Band Omni Antenna	WiFi Bullet Series
	GEM07-15072A	3G Antenna	3G Bullet Series
	GEM04-222060	Wi-Fi Dual Band Antenna	WiFi Bullet Series
	GEM04-222070	Wi-Fi Dual Band Patch Antenna	WiFi Bullet Series
Others			
	12V 4400mAh	12V Li Battery Module	Wi-Fi Box / Wi-Fi Cube Series
	72-A1030001 72-A2030001	Power Box	Speed Dome Series

Network Equipment

Networking	Model name	Product Name	Supported Models
	PS-5881	8-port 10/100M PoE Fast Ethernet Switch	Fixed Box / Fixed Dome / Mini Dome / PoE Cube Series
	PS-7242IL-AF	24-port 10/ 100M PoE Web Smart Ethernet Switch	Fixed Box / Fixed Dome / Mini Dome / PoE Cube Series
	PS-7242IL-AT	24-port 10/ 100M PoE+ Web Smart Ethernet Switch	All Brickcom cameras
	DWRT-600N	Dual Band Wireless N Router	All Brickcom cameras
	F5D4074(EU)	HomePlug Bridge	All Brickcom cameras
	POE30U	PoE Injector	Bullet / Vandal Dome / PTZ Series
	3001	PoE Injector	Fixed Box / Fixed Dome / Mini Dome / PoE Cube Series
	151S-12V	PoE Splitter	CB-100A Series
	WIXB-100	Wimax Outdoor BS	All Brickcom cameras
	WIXC-100	Wimax Outdoor CPE	All Brickcom cameras
	BP-1000	UPS power pack for camera	Fixed Box / Fixed Dome / (PoE) Cube Series
	WAP-350N	Wireless Outdoor N Access Point	All Brickcom cameras
	BA3230	Wimax Antenna	WIXC-100 / WIXC-100

Easy Installation

1 STEP Install cameras and network devices (Plug and Play)

* The WPS function can simply build up the wireless connection and encryption by pressing the WPS button on both the router and camera.

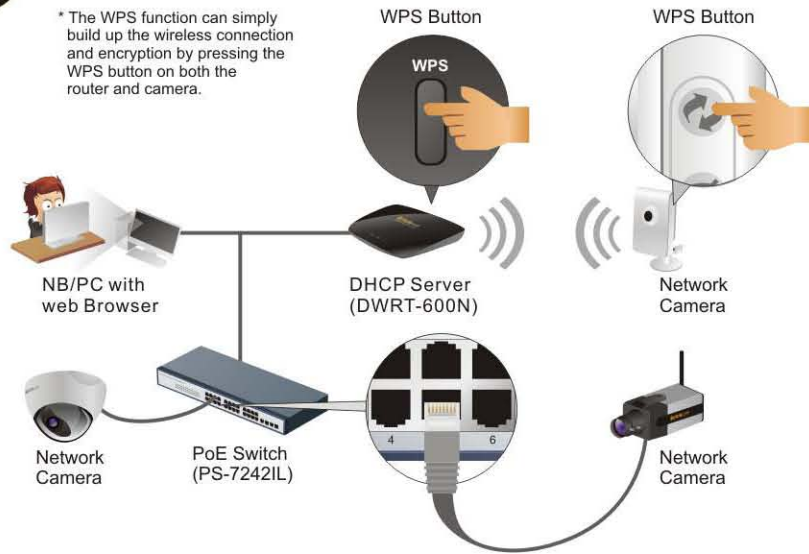

2 STEP Install the Brickcom Easyconfig program with your CD-ROM, and search for your camera without having to configure any complicated IP settings.



3 STEP Follow the EasyConfig software to configure the camera's IP address settings and EasyLink™ functions.



4 STEP Click <Live View> to view the live video feed of the connected camera.



Brickcom

© Brickcom Technology Inc., All Rights Reserved. This document is for planning purposes only, and is not intended to modify or supplement any specifications or warranties relating to products of Brickcom Technology. Brickcom may make changes to specifications and descriptions at any time, without notice.

Brickcom Corporation Headquarters

Address: No.1 Jen Ai Rd, Hsinchu Industrial Park, Hukou, Hsinchu, Taiwan, R.O.C. 303 Tel: + 886-3-5982022
 Fax: + 886-3-5982023 Mail: info@brickcom.com http://www.brickcom.com
 USA Toll Free Number: +1 800-2484060

VMS Compatible



Member of



Partner: