

### INTRODUCTION

The AW-FGT-100A is an 8 port 10/100BaseT unmanaged PoE switch capable of feeding 15.4/30W (56V max. per port) power to Power over Ethernet (PoE) devices. The switch is capable of a total of 120 Watts power budget.

### PACKAGE CONTENTS

* 1x PoE switch	* 1x Quick Installation Guide
* 2x rack mount ears	* 1x power cord (type by the shipped-to area)

### ⚠ IMPORTANT:

1. Install the PoE switch in a ventilated and dry place, that is free of electromagnetic source, vibration, moisture, and dust.
2. Make sure the ventilation openings on the switch are not blocked.
3. Use CAT5 or 6 UTP/STP cables.
4. AC input (100~240V/AC, 50~60Hz), for a max. consumption of 120W.

### CONNECTION

#### Front Panel



#### Rear Panel

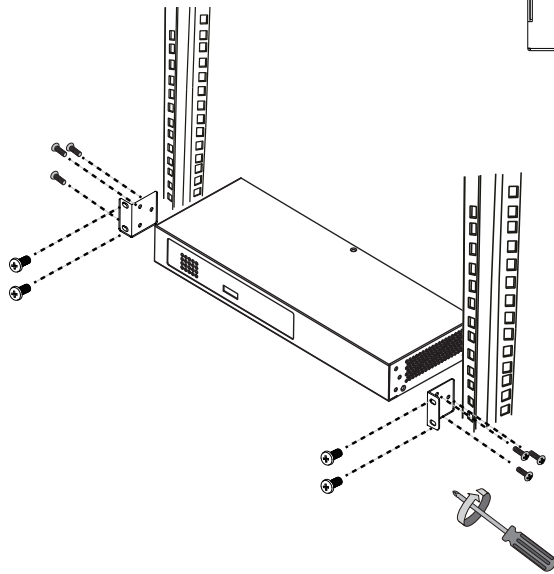
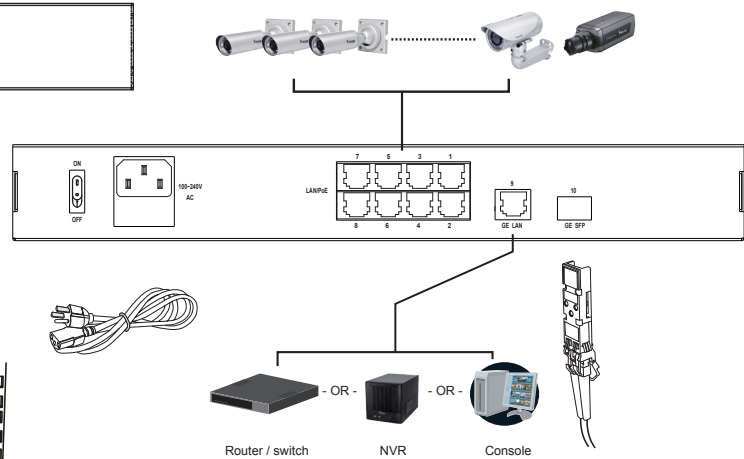

Use SFP, LC type transceiver with 100Mbps or 1Gbps transfer speed in Single mode (10km,30km,50km,80km) or Multi mode (0.5m or 2km) or Bidi (10km,30km,50km,80km).

### LED DEFINITIONS

<b>POWER</b>	Green ON	Power is on and normal.
	Green Off	Power is off.
<b>10/100M or GbE</b>	Green ON	Ethernet port is connected.
	Fast Flashing	Data is being transmitted or received.
	Off	No connection.
<b>PoE</b>	Green ON	Port is linked to a powered device.
	OFF	No device is connected.

All specifications are subject to change without notice.  
Copyright © 2014 VIVOTEK INC. All rights reserved.